



Classic *Square Edge*

The traditional self-edge profile is both clean and crisp. The perfect 90° profile is a timeless original, desirable in both Commercial and Residential settings.

 **RYNONE**[®]
Every Day!

 **Dimensions**
INDUSTRIES

The future is beyond flat.
Experience VT Dimensions.

The Classic edge profile adds dimensional beauty and character to VT Dimensions countertops. More than just a flat surface, Rynone brings everything together into one seamless and contoured offering—with the depth, the style, and seamless edge you want.

Experience a whole new dimension in countertops with Rynone ... Every Day.

Specifications

- Standard substrate is 3/4" industrial-grade particleboard, available in 8', 10', and 12' lengths
- Standard postformed-grade laminate with a thickness of 0.042" + 0.002" - 0.008"
- Both standard and special styles and sizes are suitable for all residential, commercial, institutional, or light-industrial applications
- Available surfaced with Capture by VT Dimensions®, Formica®, Nevamar®, Pionite®, and Wilsonart® laminate
- Available as an environmentally friendly EQcountertop

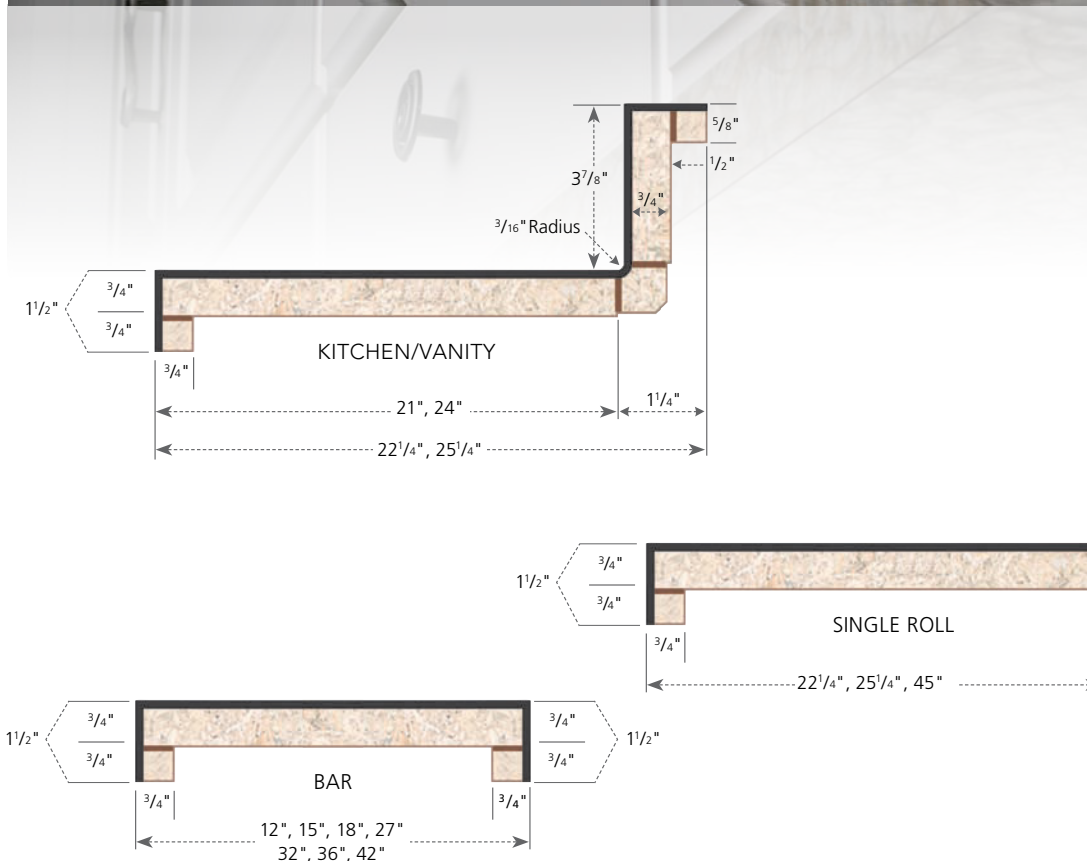

All measurements in inches. Drawings not to scale.



Rynone Manufacturing Corp.

Phone: 570-888-5272 • Fax: 570-888-1175

www.rynone.com