

POSTFORM EDGE PROFILES

TEMPO WATERFALL

One of the most popular choices with a wide variety of applications.



CAPRICE NO-DRIP

No-drip front edge to prevent spills from reaching the floor.

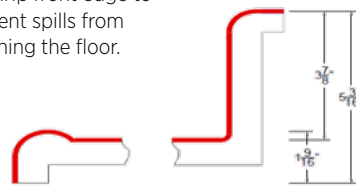

CLASSIC SQUARE

Desirable in both commercial and residential settings.



NOVA EURO ROUND

Ideal for those who prefer a rounded-edge profile design.

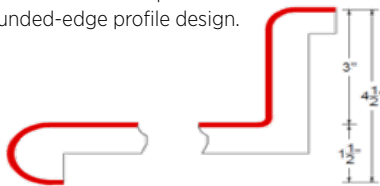

AFTON DOUBLE WATERFALL

Double waterfall ogee blend suitable for any application.

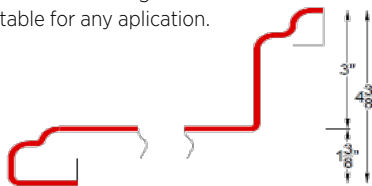

FUTURA EURO SQUARE

Seamless double-radius edge that emulates the "slab" effect.

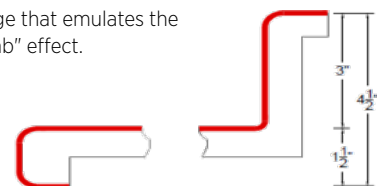

MARBELLA PENCIL

Refined and modern, bringing sophisticated style to every space.

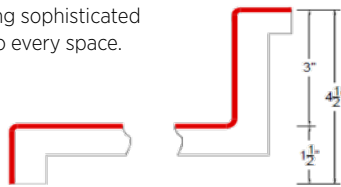

ORA FULL-WRAP PENCIL

Full-wrap pencil-edge design creates a clean and distinctive look.

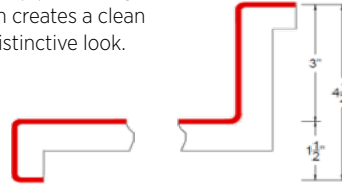

BARCELONA CONTEMPORARY OGEE

Double waterfall edge emulates natural stone and adds distinction and flair.

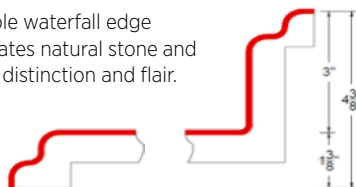

VALENCIA FULL-WRAP OGEE

Dramatic, graceful and contoured are the defining characteristics of this edge profile.

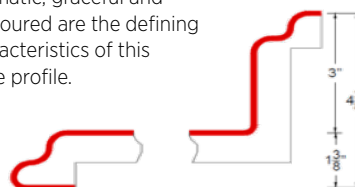

Afton Full-Wrap Contemporary Ogee

Expect More from Rynone

Bring together modern style, intriguing depth, and the seamless edge you want with the beautifully contoured look of VT Dimensions countertops. Beyond the beauty, you'll have the assurance of knowing Rynone uses the best materials and fabrication techniques to produce your project. And you get a 1-year warranty you can count on.

One source. Many beautiful looks. Every Day.



Specifications

- Standard substrate is 3/4" industrial-grade particleboard, available in 8', 10', and 12' lengths
- Standard postformed-grade laminate with a thickness of 0.042" + 0.002" - 0.008"
- Both standard and special styles and sizes are suitable for all residential, commercial, institutional, or light-industrial applications
- Available surfaced with Formica®, Nevamar®, Pionite®, and Wilsonart® laminate
- Available as an environmentally friendly EQcountertop
- Not available surfaced with solid color laminates

Edge: Afton
Laminate: Elemental Concrete
Formica® 8830-58

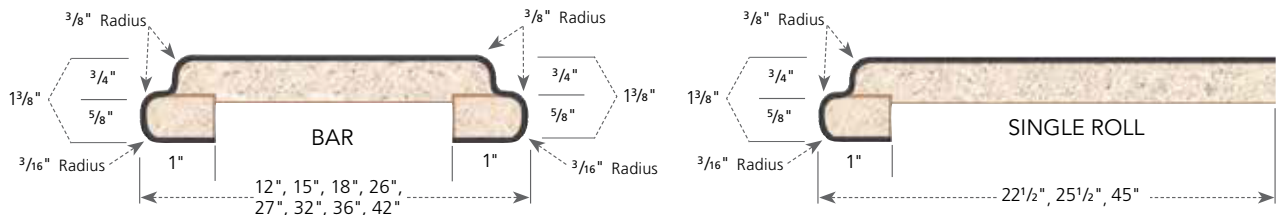
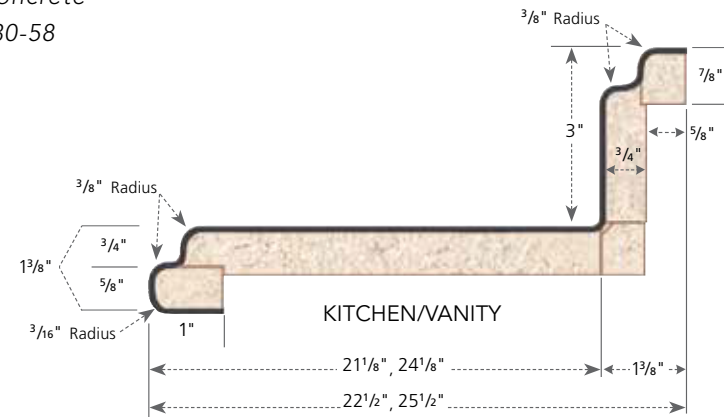

All measurements in inches. Drawings not to scale.



Rynone Manufacturing Corp.

Phone: 570-888-5272 • Fax: 570-888-1175

www.rynone.com

Barcelona Contemporary Ogee

Expect More from Rynone

Bring together modern style, intriguing depth, and the seamless edge you want with the beautifully contoured look of VT Dimensions countertops. Beyond the beauty, you'll have the assurance of knowing Rynone uses the best materials and fabrication techniques to produce your project. And you get a 1-year warranty you can count on.

One source. Many beautiful looks. Every Day.



Specifications

- Standard substrate is 3/4" industrial-grade particleboard, available in 8', 10', and 12' lengths
- Standard postformed-grade laminate with a thickness of 0.042" + 0.002" - 0.008"
- Both standard and special styles and sizes are suitable for all residential, commercial, institutional, or light-industrial applications
- Available surfaced with Formica®, Nevamar®, Pionite®, and Wilsonart® laminate
- Available as an environmentally friendly EQcountertop

Edge: Barcelona

Laminate: Florence Gold

Wilsonart® 1873-35

RYNONE
Every Day!

Rynone Manufacturing Corp.

Phone: 570-888-5272 • Fax: 570-888-1175

www.rynone.com

All measurements in inches. Drawings not to scale.

Rynone Barcelona Spec 11.17

Caprice No-Drip Edge

The future is beyond flat.
Experience VT Dimensions®

The Caprice no-drip edge profile adds dimensional beauty and character to VT Dimensions countertops. More than just a flat surface, Rynone brings everything together into one seamless and contoured offering—with the depth, style, and seamless edge you want.

Experience a whole new dimension in countertops with Rynone ... Every Day.

Specifications

- Standard substrate is 3/4" industrial-grade particleboard, available in 8', 10', and 12' lengths
- Standard postformed-grade laminate with a thickness of 0.042" + 0.002" - 0.008"
- Both standard and special styles and sizes are suitable for all residential, commercial, institutional, or light-industrial applications
- Available surfaced with Capture Collection from VT Dimensions, Formica®, Nevamar®, Pionite®, and Wilsonart® laminate
- Available as an environmentally friendly EQcountertop

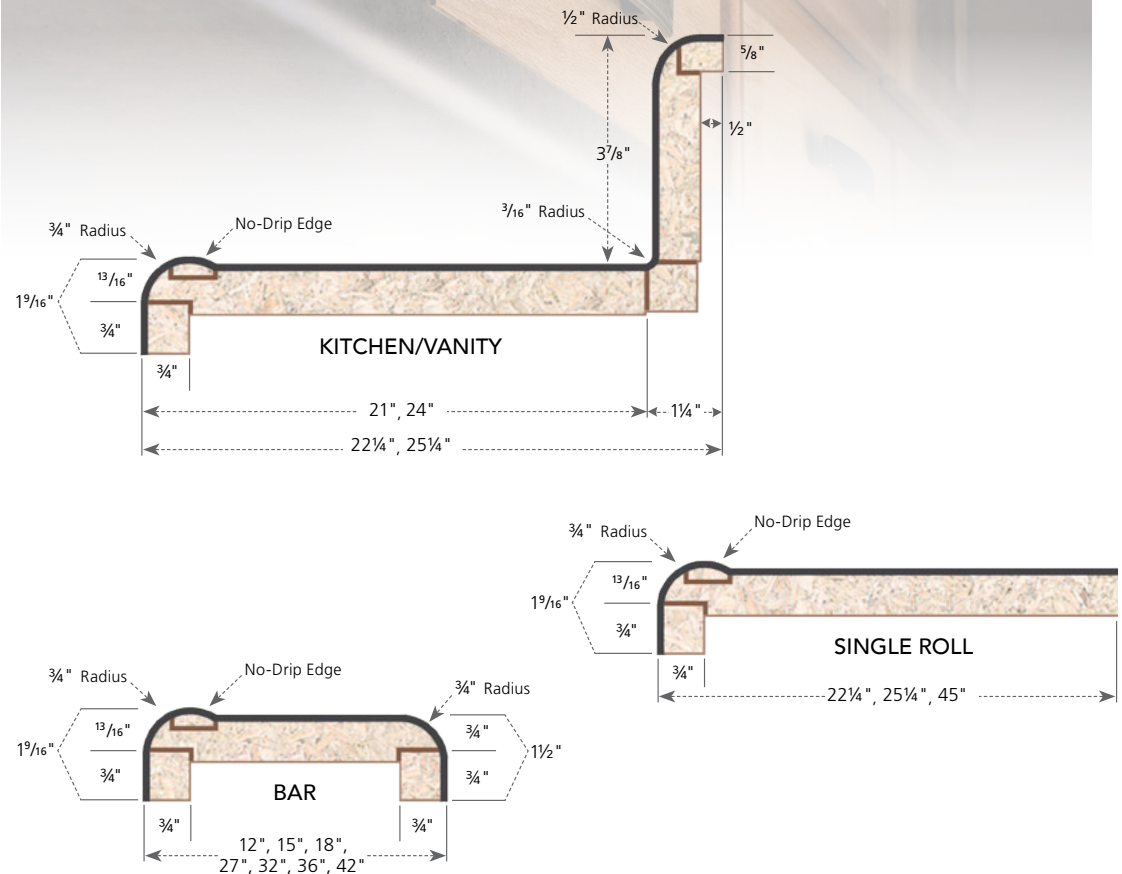

All measurements in inches. Drawings not to scale.



Rynone Manufacturing Corp.
 Phone: 570-888-5272 • Fax: 570-888-1175

www.rynone.com

COMMERCIAL LINE

Rynone Caprice Spec 11.17

The future is beyond flat.
Experience VT Dimensions.

The Classic edge profile adds dimensional beauty and character to VT Dimensions countertops. More than just a flat surface, Rynone brings everything together into one seamless and contoured offering—with the depth, the style, and seamless edge you want.

Experience a whole new dimension in countertops with Rynone ... Every Day.

Specifications

- Standard substrate is 3/4" industrial-grade particleboard, available in 8', 10', and 12' lengths
- Standard postformed-grade laminate with a thickness of 0.042" + 0.002" - 0.008"
- Both standard and special styles and sizes are suitable for all residential, commercial, institutional, or light-industrial applications
- Available surfaced with Capture by VT Dimensions®, Formica®, Nevamar®, Pionite®, and Wilsonart® laminate
- Available as an environmentally friendly EQcountertop

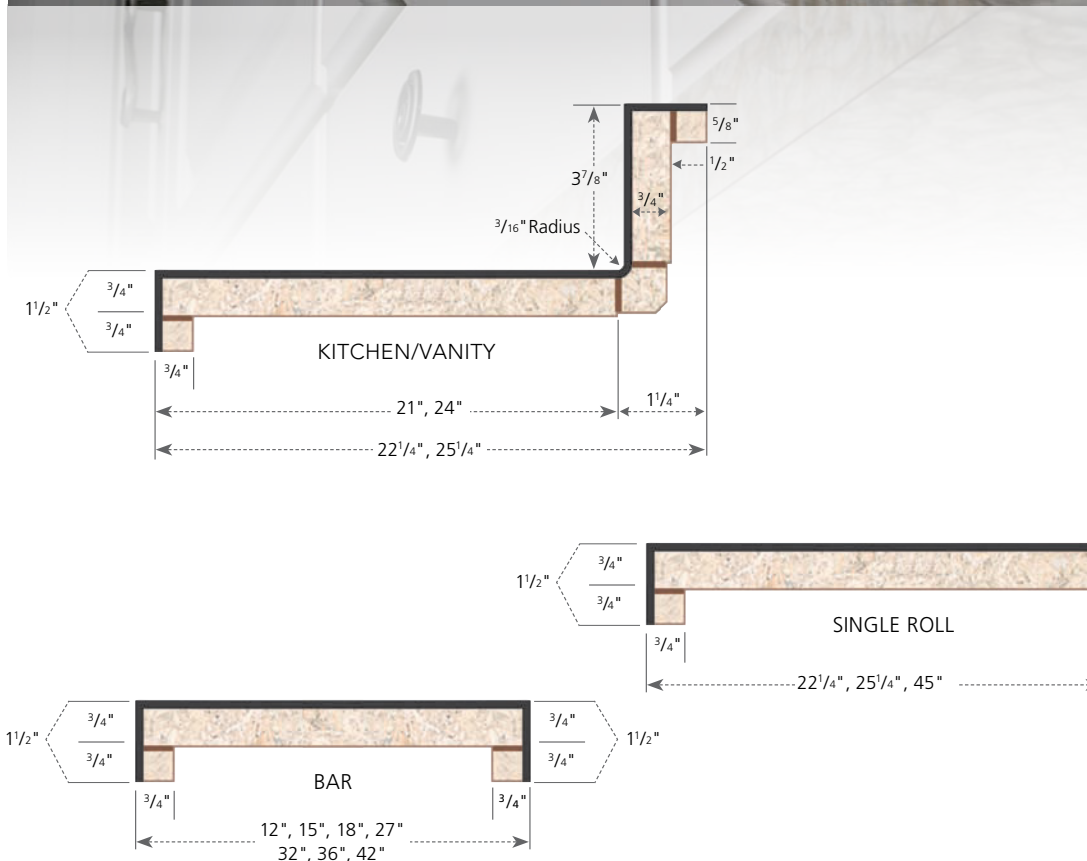

All measurements in inches. Drawings not to scale.



Rynone Manufacturing Corp.

Phone: 570-888-5272 • Fax: 570-888-1175

www.rynone.com

Futura Double-Radius Edge

The future is beyond flat. Experience VT Dimensions®

The Futura double-radius edge profile adds dimensional beauty and character to VT Dimensions countertops. More than just a flat surface, Rynone brings everything together into one seamless and contoured offering—with the depth, style, and seamless edge you want.

Experience a whole new dimension in countertops with Rynone, every day.

Specifications

- Standard substrate is $\frac{3}{4}$ " industrial-grade particleboard, available in 8', 10', and 12' lengths
- Standard postformed-grade laminate with a thickness of $0.042" + 0.002" - 0.008"$
- Both standard and special styles and sizes are suitable for all residential, commercial, institutional, or light-industrial applications
- Available surfaced with Capture Collection from VT Dimensions, Formica®, Nevamar®, Pionite®, and Wilsonart® laminate
- Available as an environmentally friendly EQcountertop

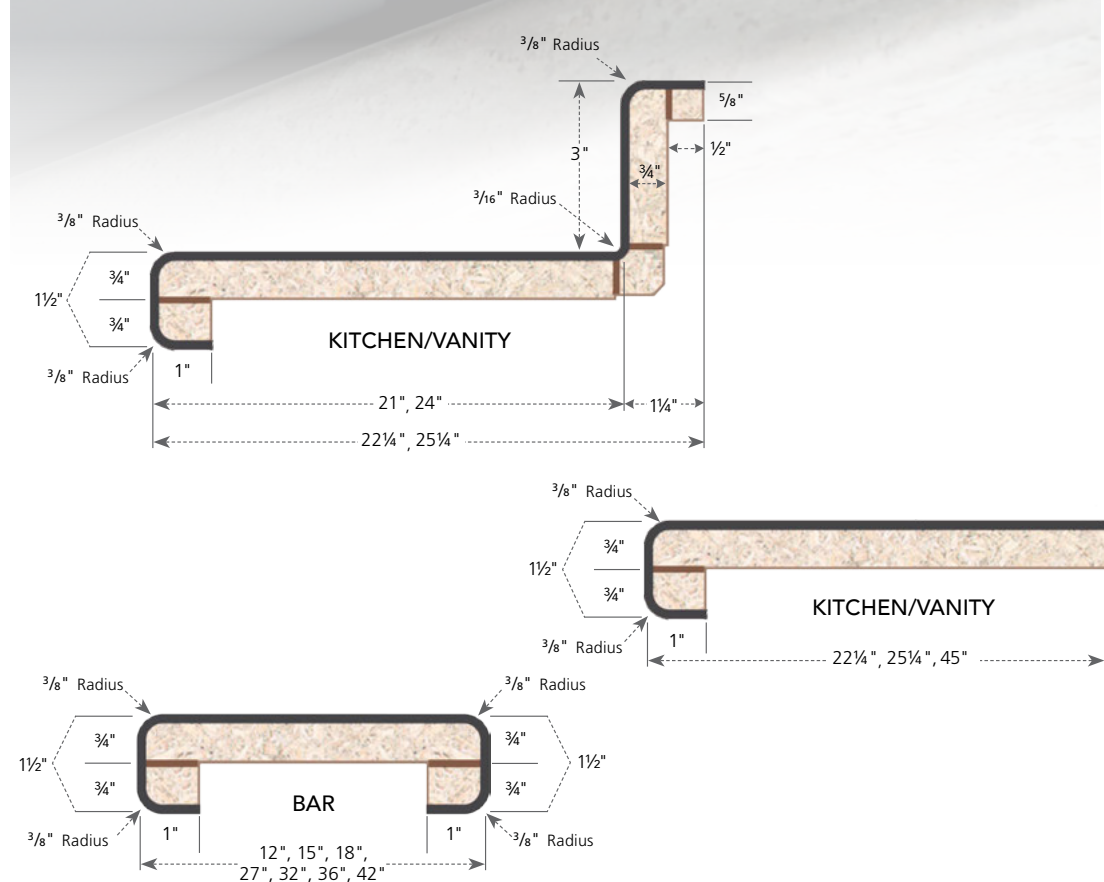

All measurements in inches. Drawings not to scale.



Rynone Manufacturing Corp.

Phone: 570-888-5272 • Fax: 570-888-1175

www.rynone.com

COMMERCIAL LINE

Rynone Futura Spec 11.17

Marbella Pencil Edge

Expect More from Rynone

Bring together modern style, intriguing depth, and the seamless edge you want with the beautifully contoured look of VT Dimensions countertops. Beyond the beauty, you'll have the assurance of knowing Rynone uses the best materials and fabrication techniques to produce your project. And you get a 1-year warranty you can count on.

One source. Many beautiful looks. Every Day.



Specifications

- Standard substrate is $\frac{3}{4}$ " industrial-grade particleboard, available in 8', 10', and 12' lengths
- Standard postformed-grade laminate with a thickness of $0.042" + 0.002" - 0.008"$
- Both standard and special styles and sizes are suitable for all residential, commercial, institutional, or light-industrial applications
- Available surfaced with Formica®, Nevamar®, Pionite®, and Wilsonart® laminate
- Available as an environmentally friendly EQcountertop
- Not available surfaced with solid color laminates

Edge: Marbella

Laminate: Old Mill Oak

Wilsonart® 7973-12

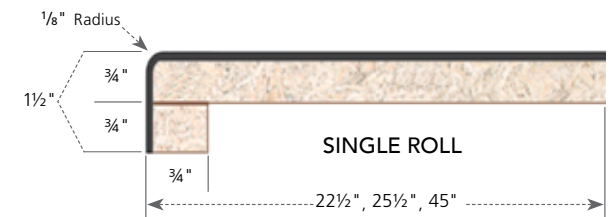
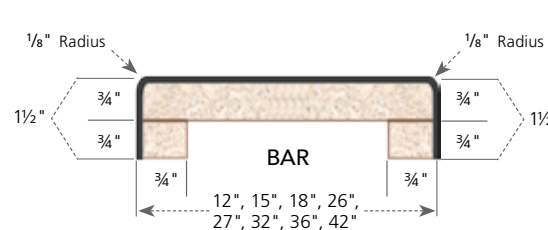
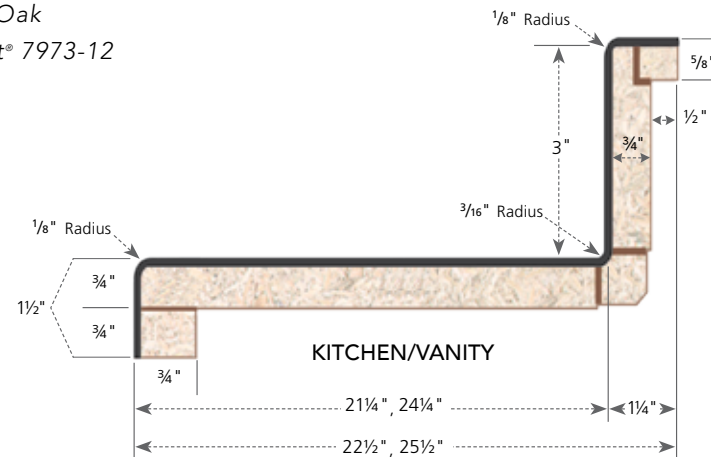

All measurements in inches. Drawings not to scale.

RYNONE
Every Day!

Rynone Manufacturing Corp.

Phone: 570-888-5272 • Fax: 570-888-1175

www.rynone.com

The future is beyond flat. Experience VT Dimensions®

The Nova 180° wrap edge profile adds dimensional beauty and character to VT Dimensions countertops. More than just a flat surface, Rynone brings everything together into one seamless and contoured offering—with the depth, style, and seamless edge you want.

Experience a whole new dimension in countertops with Rynone ... Every Day.

Specifications

- Standard substrate is 3/4" industrial-grade particleboard, available in 8', 10', and 12' lengths
- Standard postformed-grade laminate with a thickness of 0.042" + 0.002" - 0.008"
- Both standard and special styles and sizes are suitable for all residential, commercial, institutional, or light-industrial applications
- Available surfaced with Capture Collection from VT Dimensions, Formica®, Nevamar®, Pionite®, and Wilsonart® laminate
- Available as an environmentally friendly EQcountertop

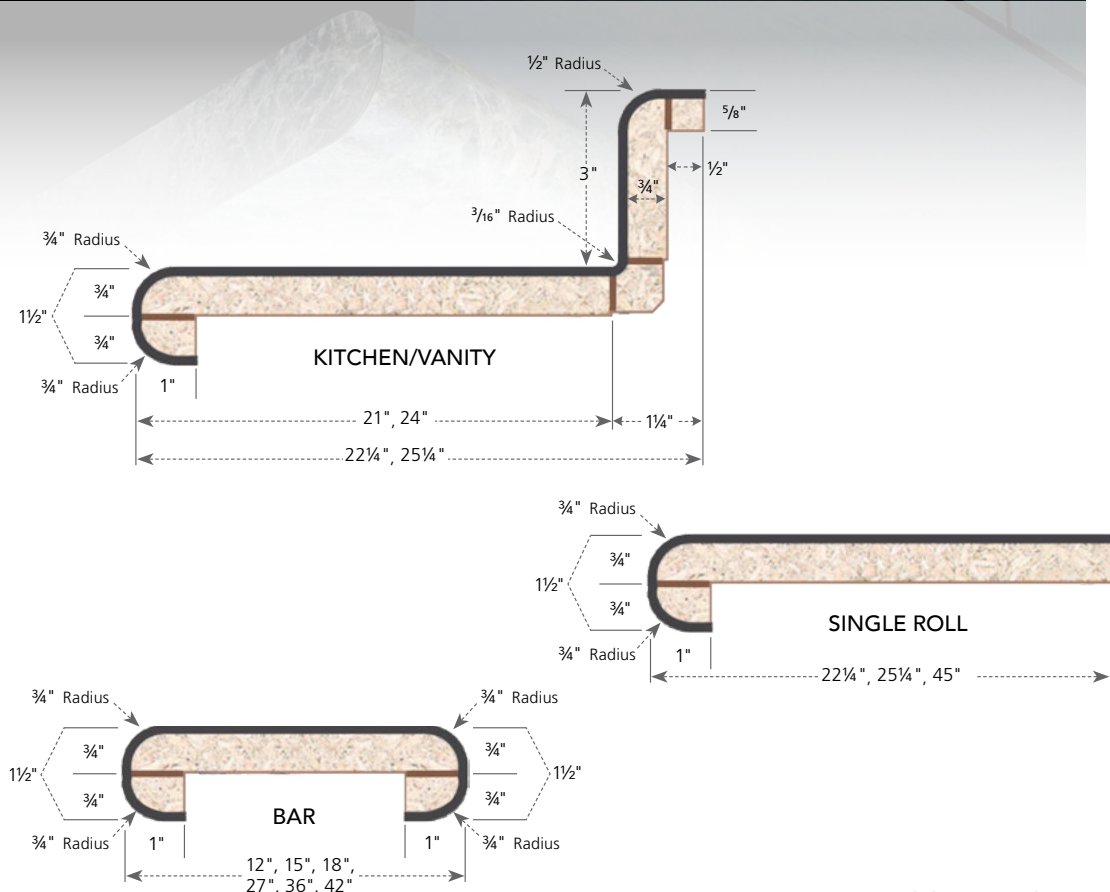

All measurements in inches. Drawings not to scale.



Rynone Manufacturing Corp.

Phone: 570-888-5272 • Fax: 570-888-1175

www.rynone.com

Ora 1/8" Radius Full-Wrap Pencil Edge

Expect More from Rynone

Bring together modern style, intriguing depth, and the seamless edge you want with the beautifully contoured look of VT Dimensions countertops. Beyond the beauty, you'll have the assurance of knowing Rynone uses the best materials and fabrication techniques to produce your project. And you get a 1-year warranty you can count on.

One source. Many beautiful looks. Every Day.



Specifications

- Standard substrate is 3/4" industrial-grade particleboard, available in 8', 10', and 12' lengths
- Standard postformed-grade laminate with a thickness of 0.042" + 0.002" - 0.008"
- Both standard and special styles and sizes are suitable for all residential, commercial, institutional, or light-industrial applications
- Available surfaced with Formica®, Nevamar®, Pionite®, and Wilsonart® laminate
- Available as an environmentally friendly EQcountertop
- Not available surfaced with solid color laminates

Edge: Ora

Laminate: Walnut Heights

Wilsonart® 7965-12

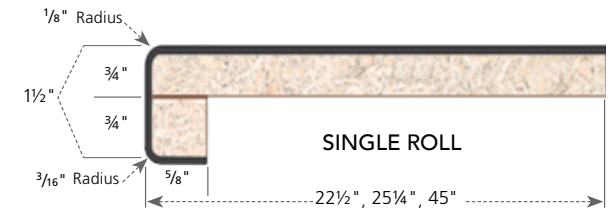
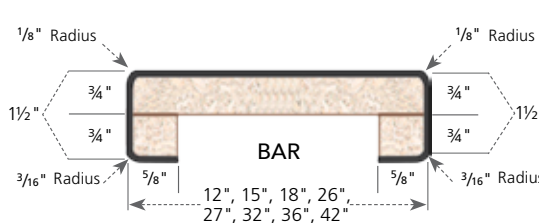
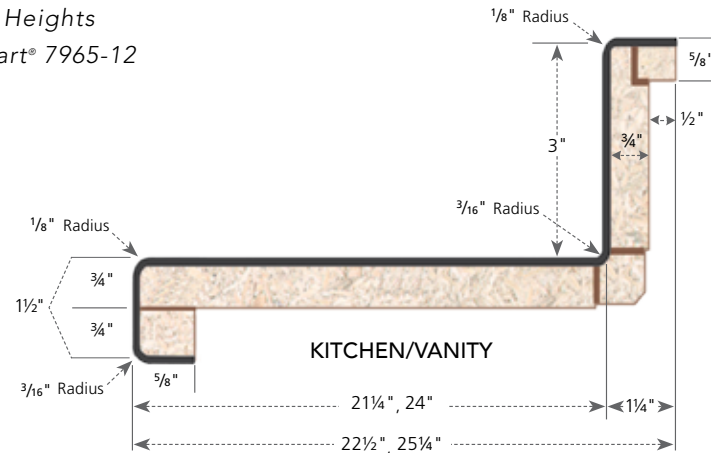

All measurements in inches. Drawings not to scale.



Rynone Manufacturing Corp.

Phone: 570-888-5272 • Fax: 570-888-1175

www.rynone.com

Tempo Waterfall Edge

The future is beyond flat. Experience VT Dimensions®

The Tempo waterfall edge profile adds dimensional beauty and character to VT Dimensions countertops. More than just a flat surface, Rynone brings everything together into one seamless and contoured offering—with the depth, style, and seamless edge you want.

Experience a whole new dimension in countertops with Rynone ... Every Day.

Specifications

- Standard substrate is $\frac{3}{4}$ " industrial-grade particleboard, available in 8', 10', and 12' lengths
- Standard postformed-grade laminate with a thickness of $0.042" + 0.002" - 0.008"$
- Both standard and special styles and sizes are suitable for all residential, commercial, institutional, or light-industrial applications
- Available surfaced with Capture Collection from VT Dimensions, Formica®, Nevamar®, Pionite®, and Wilsonart® laminate
- Available as an environmentally friendly EQcountertop

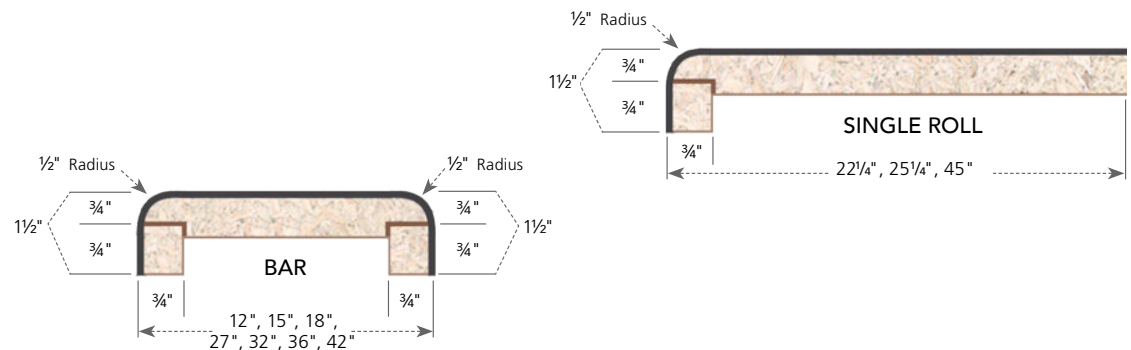
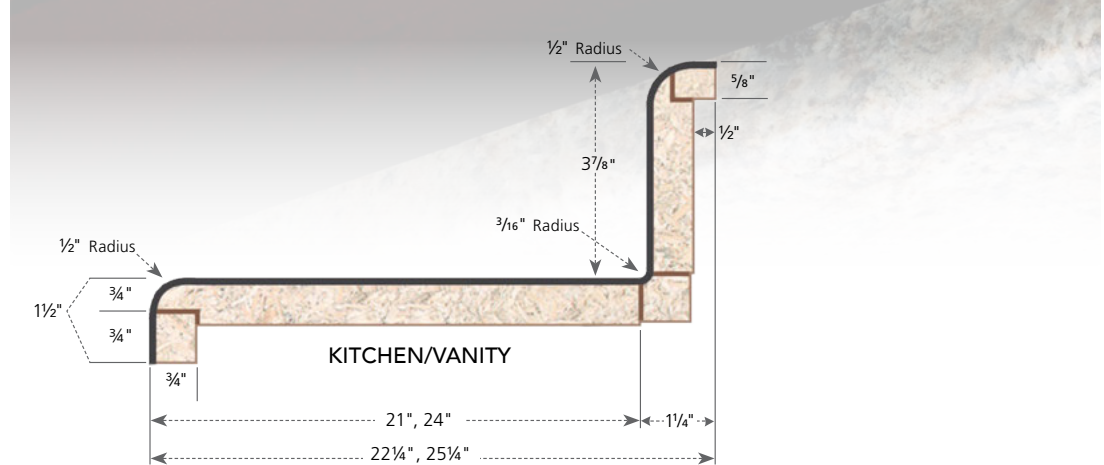

All measurements in inches. Drawings not to scale.



Rynone Manufacturing Corp.

Phone: 570-888-5272 • Fax: 570-888-1175

www.rynone.com

COMMERCIAL LINE

Rynone Tempo Spec 11.17

The future is beyond flat.
Experience VT Dimensions.

The Valencia full-wrap ogee profile adds dimensional beauty and character to VT Dimensions countertops. More than just a flat surface, Rynone brings everything together into one seamless and contoured offering—with the depth, the style, and seamless edge you want.

Experience a whole new dimension in countertops with Rynone ... Every Day.

Specifications

- Standard substrate is 3/4" industrial-grade particleboard, available in 8', 10', and 12' lengths
- Standard postformed-grade laminate with a thickness of 0.042" + 0.002" - 0.008"
- Both standard and special styles and sizes are suitable for all residential, commercial, institutional, or light-industrial applications
- Available surfaced with Formica®, Nevamar®, Pionite®, and Wilsonart® laminate
- Available as an environmentally friendly EQcountertop

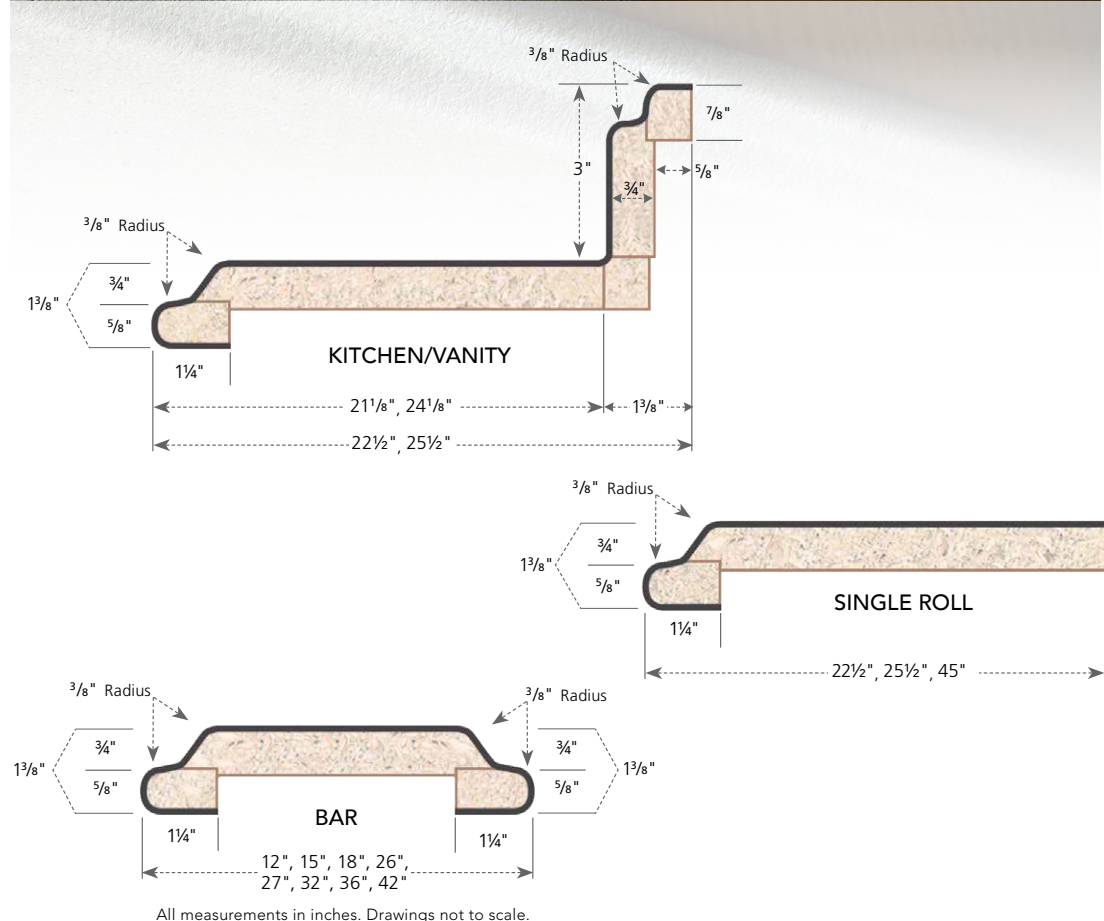

Rynone Manufacturing Corp.
 Phone: 570-888-5272 • Fax: 570-888-1175

www.rynone.com